

 **General Information**

Project Name: \_\_\_\_\_

Consultant: \_\_\_\_\_

Item #: \_\_\_\_\_

Model #: \_\_\_\_\_

Quantity: \_\_\_\_\_



Model # SCS-1 Shown  
with No Drainboards  
& Optional Overflow Hole

 **Specifications**

**SCS** Model Scullery Sinks are constructed of 14GA or 16GA type 300 series stainless steel with single or multi-compartment bowls and double wall separators. Sinks are mounted on 16GA, 1 5/8" stainless steel tubes with stainless steel adjustable feet for leveling. Sink bowls are covered at all corners and pitched to a 3 1/2" waste cutout.

Full length backsplash is 10" high and holes for faucets 8" on center accommodates your choice of faucets. The entire unit is finished with a satin brush finish.

Sound Deadening is standard on all scullery sinks.

 **Product Guide**

IMC Scullery/Service Sinks Model "SCS" are designed for heavy duty application in large or medium Institutional Facilities or where constant use is likely.

Options available are designed to make this product suitable in a variety of locations in the facility for applications, such as Deli, Vegetable or Bakery sinks or for pot cleaning.

**DRAWINGS**

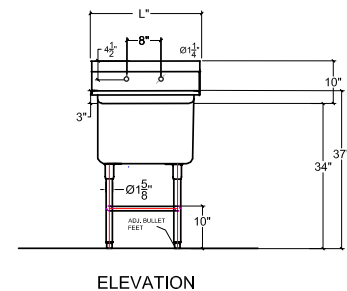
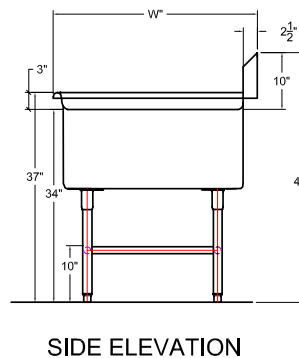
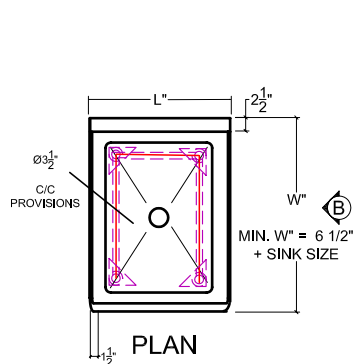

\*Non-flush front: add sink bowl size + 6 1/2" for extra width



SCS (ND) 60 0322

### 1 COMPARTMENT SCULLERY SINK

No Drainboards			
14GA Model	16GA Model	Overall Size (W x L x H)	Bowl Size
<input type="checkbox"/> SCS-14-1620	<input type="checkbox"/> SCS-16-1620	24" x 19" x 44"	16" x 20"
<input type="checkbox"/> SCS-24-1620	<input type="checkbox"/> SCS-26-1620	24" x 36" x 44"	16" x 20"
<input type="checkbox"/> SCS-34-1620	<input type="checkbox"/> SCS-36-1620	24" x 53" x 44"	16" x 20"
<input type="checkbox"/> SCS-44-1620	<input type="checkbox"/> SCS-46-1620	24" x 70" x 44"	16" x 20"
<input type="checkbox"/> SCS-14-2020	<input type="checkbox"/> SCS-16-2020	24" x 23" x 44"	20" x 20"
<input type="checkbox"/> SCS-24-2020	<input type="checkbox"/> SCS-26-2020	24" x 44" x 44"	20" x 20"
<input type="checkbox"/> SCS-34-2020	<input type="checkbox"/> SCS-36-2020	24" x 65" x 44"	20" x 20"
<input type="checkbox"/> SCS-44-2020	<input type="checkbox"/> SCS-46-2020	24" x 86" x 44"	20" x 20"
<input type="checkbox"/> SCS-14-2424	<input type="checkbox"/> SCS-16-2424	28" x 27" x 44"	24" x 24"
<input type="checkbox"/> SCS-24-2424	<input type="checkbox"/> SCS-26-2424	28" x 52" x 44"	24" x 24"
<input type="checkbox"/> SCS-34-2424	<input type="checkbox"/> SCS-36-2424	28" x 77" x 44"	24" x 24"
<input type="checkbox"/> SCS-44-2424	<input type="checkbox"/> SCS-46-2424	28" x 102" x 44"	24" x 24"
<input type="checkbox"/> SCS-14-2028	<input type="checkbox"/> SCS-16-2028	32" x 27" x 44"	20" x 28"
<input type="checkbox"/> SCS-24-2028	<input type="checkbox"/> SCS-26-2028	32" x 44" x 44"	20" x 28"
<input type="checkbox"/> SCS-34-2028	<input type="checkbox"/> SCS-36-2028	32" x 65" x 44"	20" x 28"
<input type="checkbox"/> SCS-44-2028	<input type="checkbox"/> SCS-46-2028	32" x 86" x 44"	20" x 28"

### OPTIONS

- KPSF** - 12" Kettle & Pot Sink Faucet
- CU-12** - 12GA S/S Channel Upgrade
- CU-14** - 14GA S/S Channel Upgrade
- US-16** - 16GA S/S Undershelf Upgrade
- 16D-1** - 16" Deep Sink in Lieu of Standard
- BDR** - Basket Drain (Replacement)
- CC** - Corner or Column Cut Out
- CRT** - Corner Turn
- ERCO** - Electrical Receptacle Cutout Only
- ERCB** - Electrical Receptacle with Cover & Box (220V, 30 Amps max)
- EBS** - Enclosed Backsplash
- FF-50** - Flanged Feet (Each)
- STG** - Flat S/S Perforated Sanitizer Guard
- RSP** - Integral Side Splash (Each)
- LD** - Lever Drain
- LDO** - Lever Drain with Overflow
- NFF** - Non-Flush Front (Increases W)
- OFC** - Overflow Compartment
- PRFF** - Pre-Rinse Unit - 4" Centers, Splash Mounted
- PVH** - Provision for Heater
- PUD** - Provision for Undercounter Dishwasher
- PWP** - Provision for Water Pump
- RG** - Rack Guide
- RSC** - Raised S/S Scrap Chute - 6" Dia, Raised Edge, 3" Deep
- SB** - Scrap Basket
- SRB** - Scrap Block
- WCR** - Set-Up Welded Table & Crated
- SS810** - Side Splash 8" or 10" High
- SCV** - Sink Cover - Stainless Steel
- SDE** - Sound Deadening (Standard)
- SSA** - Stainless Steel Apron
- SSU** - Stainless Steel Undershelf - 18GA
- SPB** - Support Bracket for Lever Drain Handle
- UC** - Utility Chase
- WTR-48** - Waste Trough 6" x 48" x 4" Deep
- WDC** - Weld in Disposer Cone with Control Bracket
- WSTS** - Weld Scrap Sink/Disposer or Trough to Sink
- WHR** - Working Height Revision

Specifications subject to change without notice.

SCS (ND) 60 0322