



Chef Tables - Stainless Steel Top with 5" Riser

Stainless Steel Cabinet Base Tables with Sliding Doors

Certifications:



Features:

- 1 ^{5/8}" x 6" Straight S/S Leg
- Sliding Doors
- 5" Riser
- 96" Units have a Center Mullion with Two Sets of 48" Doors
- Legs Adjust 1" in Height
- Casters Available



Material:

- T-304 14 ga. Stainless Steel Top
- T-304 18 ga. Stainless Steel Body
- Stainless Steel Legs & Feet

Options:

- Adjustable Shelf



Length	24" Width	Product Weight (lbs)	30" Width	Product Weight (lbs)
36"	CSTR5-2436S	122.00	CSTR5-3036S	151.00
48"	CSTR5-2448S	156.00	CSTR5-3048S	190.00
60"	CSTR5-2460S	201.00	CSTR5-3060S	210.00
72"	CSTR5-2472S	215.00	CSTR5-3072S	234.00
84"	-	-	CSTR5-3084S	-
96"	-	-	CSTR5-3096S	-
120"	-	-	CSTR5-30120S	557.00

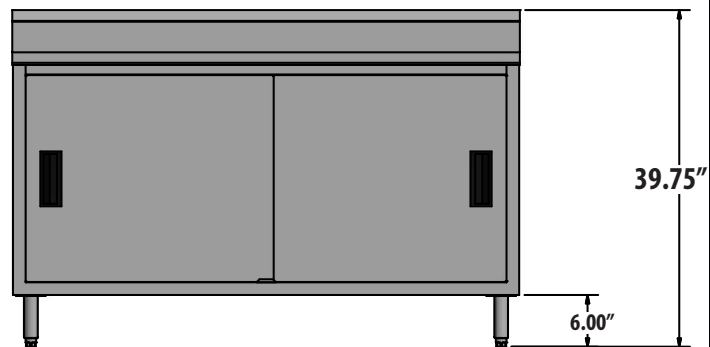
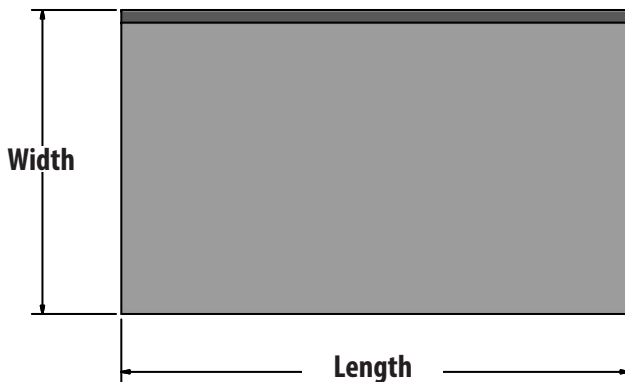

PRODUCT DATA SHEET

BK RESOURCES

