



RESOURCES

# Chef Tables - Stainless Steel Top with 5" Riser

Stainless Steel Cabinet Base Tables with Hinged Doors

## Certifications:



## Features:

- 1 5/8" x 6" Straight S/S Leg
- 5" Riser
- Hinged Doors with or without Lock
- 96" Units have a Center Mullion with Two Sets of 48" Doors
- Legs Adjust 1" in Height
- Casters Available



## Material:

- T-304 14 ga. Stainless Steel Top
- T-304 18 ga. Stainless Steel Body
- Stainless Steel Legs & Feet

## Options:

- Adjustable Shelf



## Single Sided:

Length	Hinged Door	Hinged Door	Hinged Door + Lock	Hinged Door + Lock
	24" Width	30" Width	24" Width	30" Width
18"	CSTR5-2418H	CSTR5-3018H	CSTR5-2418HL	CSTR5-3018HL
24"	CSTR5-2424H	-	CSTR5-2424HL	-
30"	-	CSTR5-3030H	-	CSTR5-3030HL
36"	CSTR5-2436H	CSTR5-3036H	CSTR5-2436HL	CSTR5-3036HL
48"	CSTR5-2448H	CSTR5-3048H	CSTR5-2448HL	CSTR5-3048HL
60"	CSTR5-2460H	CSTR5-3060H	CSTR5-2460HL	CSTR5-3060HL
72"	CSTR5-2472H	CSTR5-3072H	CSTR5-2472HL	CSTR5-3072HL
84"	-	CSTR5-3084H	-	CSTR5-3084HL
96"	-	CSTR5-3096H*	-	CSTR5-3096HL*
120"	-	CSTR5-30120H*	-	CSTR5-30120HL*

\* Has a Center Mullion with Two Sets of 48" Doors on Each Side

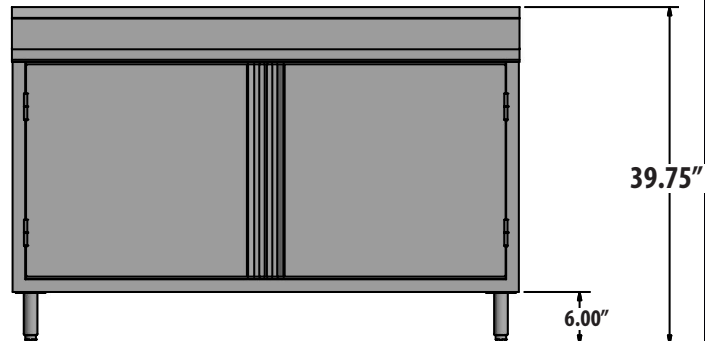
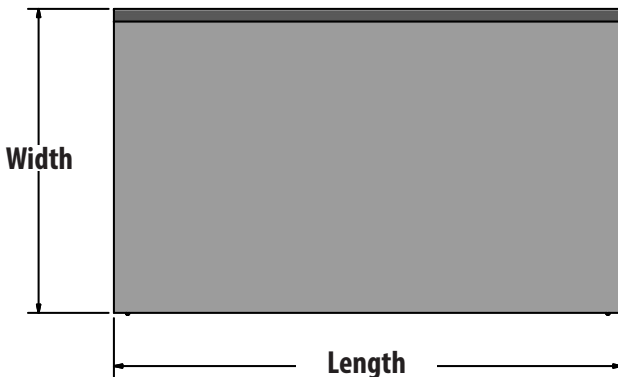

PRODUCT DATA SHEET

RESOURCES

